

FORM NO 1.

6441

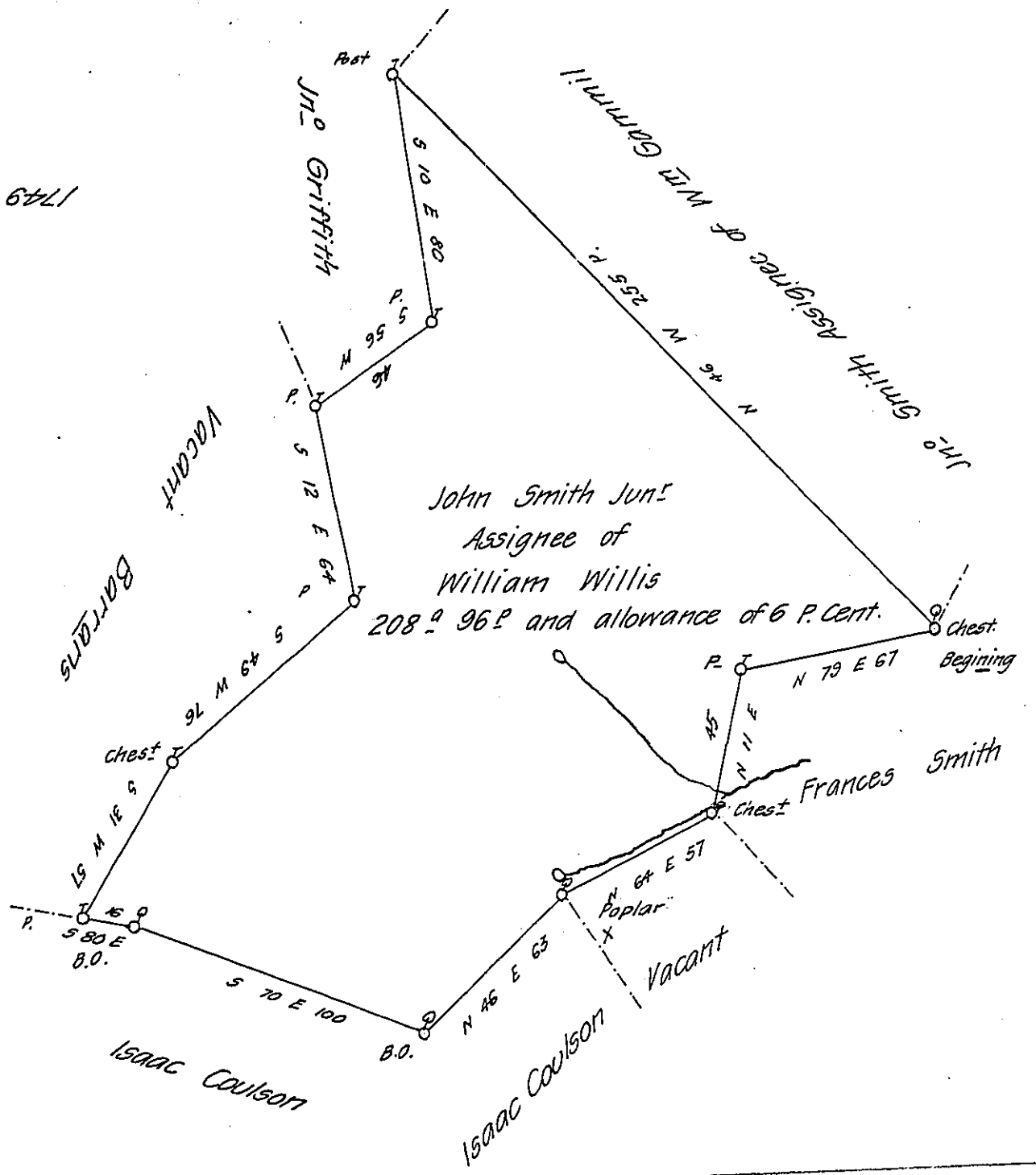

A draught of a tract of land Situate in Shrewsbury Township York
 County formerly Hallam Township Lancaster County Survey'd to John Smith Junr
 Assignee of Wm Willis in Pursuance of a Warrant for two hundred Acres date 20th
 Eighteenth day of August 1766 Survey'd the fifteenth day of the third month 1766

To John Lukens Esq^r Pr. Wm Matthews D.S.
 Su oblitzd

IN TESTIMONY that the above is a copy of the original remaining on file in
 the Department of Internal Affairs of Pennsylvania, made
 conformably to an Act of Assembly approved the 16th day of
 February, 1833, I have hereunto set my Hand and caused
 the Seal of said Department to be affixed at Harrisburg,
 this fifth day of May 1908

Henry Hauck
 Secretary of Internal Affairs.